

# Small enclosures

---

## Polycarbonate enclosures PK

Polycarbonate enclosures PK .....	36
Accessories .....	39

## Cast aluminium enclosures GA

Cast aluminium enclosures GA .....	40
Accessories .....	41

## Terminal boxes KL

Terminal boxes KL .....	42
-------------------------	----

## E-Box EB

E-Box EB .....	46
----------------	----

## Bus enclosures BG

Bus enclosures BG .....	48
-------------------------	----



# Polycarbonate enclosures PK



PK accessories Page 39 System accessories Page 613 Cable gland, polyamide Page 776

## Applications:

- Ambient temperature range: -35°C...+80°C
- The specified temperatures may be limited by the installed equipment

## Material:

- Housing: Fibre-glass reinforced polycarbonate
- Cover grey: Fibreglass-reinforced polycarbonate, all-round foamed-in PU seal
- Cover transparent: Polycarbonate, all-round foamed-in PU seal
- Cover screws: Polyamide
- Insulating bungs: Polyethylene

## Colour:

- RAL 7035

## Protection category IP to IEC 60 529:

- IP 66

## Protection category NEMA:

- NEMA 4X

## Supply includes:

- Enclosure with cover
- Cover screws
- Insulating bungs for wall mounting screws

## Approvals:

- UL
- cUL

## without knockouts

Width mm		65	94	94	94	110	110	Page
Height mm		65	65	94	94	110	110	
Depth mm		57	57	57	81	66	90	
<b>Model No.</b>		<b>9500.000</b>	<b>9502.000</b>	<b>9504.000</b>	<b>9505.000</b>	<b>9506.000</b>	<b>9507.000</b>	
	Packs of	12 pc(s).	8 pc(s).	6 pc(s).	6 pc(s).	6 pc(s).	6 pc(s).	
Cover	grey	■	■	■	■	■	■	
<b>Accessories</b>								
Mounting plate		-	-	-	-	-	-	
Hinges		-	-	-	-	-	-	
Wall mounting brackets	40 pc(s).	9583.000	9583.000	9583.000	9583.000	9583.000	9583.000	39

## without knockouts

Width mm		130	130	130	130	180	180	Page
Height mm		94	94	130	130	94	94	
Depth mm		57	81	75	99	57	81	
<b>Model No.</b>		<b>9508.000</b>	<b>9509.000</b>	<b>9510.000</b>	<b>9511.000</b>	<b>9512.000</b>	<b>9513.000</b>	
	Packs of	4 pc(s).	4 pc(s).	4 pc(s).	4 pc(s).	2 pc(s).	2 pc(s).	
Cover	grey	■	■	■	■	■	■	
<b>Accessories</b>								
Mounting plate		-	-	-	-	-	-	
Hinges		-	-	-	-	-	-	
Wall mounting brackets	40 pc(s).	9583.000	9583.000	9583.000	9583.000	9583.000	9583.000	39

# Polycarbonate enclosures PK

## without knockouts

<b>Width</b> mm	Packs of	180	180	180	180	180	180	Page
<b>Height</b> mm		110	110	110	110	110	110	
<b>Depth</b> mm		90	90	111	111	165	165	
<b>Model No.</b>	2 pc(s).	<b>9514.000</b>	<b>9514.100</b>	<b>9515.000</b>	<b>9515.100</b>	<b>9516.000</b>	<b>9516.100</b>	
Cover	grey	■	–	■	–	■	–	
	transparent	–	■	–	■	–	■	
<b>Accessories</b>								
Mounting plate		–	–	–	–	–	–	
Hinges	20 pc(s).	9581.000	9581.000	9581.000	9581.000	9581.000	9581.000	39
Wall mounting brackets	40 pc(s).	9583.000	9583.000	9583.000	9583.000	9583.000	9583.000	39

## without knockouts

<b>Width</b> mm	Packs of	182	182	182	182	182	182	Page
<b>Height</b> mm		180	180	180	180	180	180	
<b>Depth</b> mm		90	90	111	111	165	165	
<b>Model No.</b>	1 pc(s).	<b>9517.000</b>	<b>9517.100</b>	<b>9518.000</b>	<b>9518.100</b>	<b>9519.000</b>	<b>9519.100</b>	
Cover	grey	■	–	■	–	■	–	
	transparent	–	■	–	■	–	■	
<b>Accessories</b>								
Mounting plate	10 pc(s).	9548.000	9548.000	9548.000	9548.000	9548.000	9548.000	39
Hinges	20 pc(s).	9581.000	9581.000	9581.000	9581.000	9581.000	9581.000	39
Wall mounting brackets	40 pc(s).	9583.000	9583.000	9583.000	9583.000	9583.000	9583.000	39

## without knockouts

<b>Width</b> mm	Packs of	254	254	254	254	254	254	Page
<b>Height</b> mm		180	180	180	180	180	180	
<b>Depth</b> mm		90	90	111	111	165	165	
<b>Model No.</b>	1 pc(s).	<b>9520.000</b>	<b>9520.100</b>	<b>9521.000</b>	<b>9521.100</b>	<b>9522.000</b>	<b>9522.100</b>	
Cover	grey	■	–	■	–	■	–	
	transparent	–	■	–	■	–	■	
<b>Accessories</b>								
Mounting plate	8 pc(s).	9549.000	9549.000	9549.000	9549.000	9549.000	9549.000	39
Hinges	20 pc(s).	9581.000	9581.000	9581.000	9581.000	9581.000	9581.000	39
Wall mounting brackets	40 pc(s).	9583.000	9583.000	9583.000	9583.000	9583.000	9583.000	39

## without knockouts

<b>Width</b> mm	Packs of	360	360	360	360	360	360	Page
<b>Height</b> mm		254	254	254	254	254	254	
<b>Depth</b> mm		111	111	165	165	165	165	
<b>Model No.</b>	1 pc(s).	<b>9523.000</b>	<b>9523.100</b>	<b>9524.000</b>	<b>9524.100</b>	<b>9524.000</b>	<b>9524.100</b>	
Cover	grey	■	–	■	–	■	–	
	transparent	–	■	–	■	–	■	
<b>Accessories</b>								
Mounting plate	4 pc(s).	9550.000	9550.000	9550.000	9550.000	9550.000	9550.000	39
Hinges	20 pc(s).	9581.000	9581.000	9581.000	9581.000	9581.000	9581.000	39
Wall mounting brackets	40 pc(s).	9583.000	9583.000	9583.000	9583.000	9583.000	9583.000	39

# Polycarbonate enclosures PK



PK accessories Page 39 System accessories Page 613 Cable gland, polyamide Page 776

### Applications:

- Ambient temperature range: -35°C...+80°C
- The specified temperatures may be limited by the installed equipment

### Material:

- Housing: Fibre-glass reinforced polycarbonate
- Cover: Fibreglass-reinforced polycarbonate, all-round foamed-in PU seal
- Cover screws: Polyamide
- Insulating bungs: Polyethylene

### Colour:

- RAL 7035

### Protection category IP to IEC 60 529:

- IP 66

### Protection category NEMA:

- NEMA 4X

### Supply includes:

- Enclosure with cover
- Cover screws
- Insulating bungs for wall mounting screws

### Approvals:

- UL
- cUL
- Bureau Veritas

## with knockouts

Width mm		130	180	254	Page
Height mm		94	110	180	
Depth mm		57	90	111	
<b>Model No.</b>		<b>9508.050</b>	<b>9514.050</b>	<b>9521.050</b>	
	Packs of	4 pc(s).	2 pc(s).	1 pc(s).	
Cover	grey	■	■	■	
No. of metric knockouts		10 x M16/M20	16 x M20 2 x M20/M25 2 x M32/M40	24 x M20 4 x M25/M32 4 x M32/M40	
<b>Accessories</b>					
Mounting plate	8 pc(s).	-	-	9549.000	39
Wall mounting brackets	40 pc(s).	9583.000	9583.000	9583.000	39

# Polycarbonate enclosures PK

## Accessories

### Mounting plate

#### for PK

For individual interior installation.

#### Material:

- 2.5 mm melamine phenol-coated laminated paper.

#### Colour:

- RAL 7035

#### Supply includes:

- Mounting plate
- Self-tapping assembly screws

Mounting plate width mm	Mounting plate height mm	For enclosure width mm	For enclosure height mm	Packs of	Model No.
150	150	182	180	10 pc(s).	<b>9548.000</b>
220	150	254	180	8 pc(s).	<b>9549.000</b>
331	220	360	254	4 pc(s).	<b>9550.000</b>

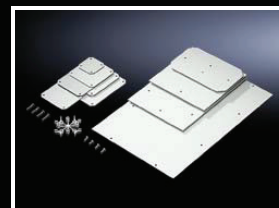

### Hinges

#### for PK

For hinged attachment of covers. The supplied drilling template ensures problem-free assembly.

#### Material:

- Polystyrene

#### Colour:

- Similar to RAL 7035

#### Supply includes:

- 20 hinges
- Assembly parts

For enclosure height mm	For enclosure depth mm	Material	Packs of	Model No.
≥ 110	≥ 180	Poly-styrene	20 pc(s).	<b>9581.000</b>



### Wall mounting brackets

#### for PK

The enclosure can be screwed to the wall using four wall mounting brackets. The bracket is securely attached to the enclosure by means of pins.

#### Applications:

- For all PK enclosures

#### Material:

- Polyamide, grey

#### Colour:

- Similar to RAL 7035

Packs of	Model No.
40 pc(s).	<b>9583.000</b>

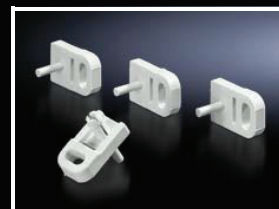

# Cast aluminium enclosures GA



GA accessories Page 41 System accessories Page 613

### Material:

- Enclosure: Cast aluminium
- Cover: Cast aluminium, all-round CR cellular rubber cord seal

### Surface finish:

- Textured paint

### Colour:

- RAL 7001

### Protection category IP to IEC 60 529:

- IP 66

### Protection category NEMA:

- NEMA 4

### Supply includes:

- Enclosure with cover
- Cover screws, captive
- Screws for attaching support rails
- Screw for connection of the PE conductor

<b>Width</b> mm		58	98	75	125	175	250	122	220	Page
<b>Height</b> mm		64	64	80	80	80	80	120	120	
<b>Depth</b> mm		34	35	57	57	57	57	80	91	
<b>Model No.</b>		<b>9101.210</b>	<b>9102.210</b>	<b>9104.210</b>	<b>9105.210</b>	<b>9106.210</b>	<b>9107.210</b>	<b>9108.210</b>	<b>9110.210</b>	
	Packs of	5 pc(s).	3 pc(s).	1 pc(s).	1 pc(s).	1 pc(s).	1 pc(s).	1 pc(s).	1 pc(s).	

### Accessories

Mounting plate		–	–	–	9105.700	–	–	9108.700	9110.700	41
	Packs of	–	–	–	10 pc(s).	–	–	2 pc(s).	2 pc(s).	
Wall mounting bracket	2 pc(s).	–	–	–	–	–	–	9121.122	9121.122	41
Support rails		see page	see page	see page	see page	see page	see page	see page	see page	725
Hinge, exterior	2 pc(s).	–	–	–	–	–	–	9123.000	9123.000	41
Earth straps		see page	see page	see page	see page	see page	see page	see page	see page	762
Cable gland, brass		see page	see page	see page	see page	see page	see page	see page	see page	776
Cable gland, polyamide		see page	see page	see page	see page	see page	see page	see page	see page	776

<b>Width</b> mm	Packs of	360	160	260	360	202	280	334	330	Page
<b>Height</b> mm		120	160	160	160	232	232	233	230	
<b>Depth</b> mm		82	91	91	91	111	111	111	181	
<b>Model No.</b>	1 pc(s).	<b>9111.210</b>	<b>9112.210</b>	<b>9113.210</b>	<b>9114.210</b>	<b>9116.210</b>	<b>9117.210</b>	<b>9118.210</b>	<b>9119.210</b>	

### Accessories

Mounting plate		–	9112.700	9113.700	9114.700	9116.700	9117.700	9118.700	9118.700	41
	Packs of	–	2 pc(s).	2 pc(s).	1 pc(s).	1 pc(s).	1 pc(s).	1 pc(s).	1 pc(s).	
Wall mounting bracket	2 pc(s).	9121.122	9121.160	9121.160	9121.160	9121.230	9121.230	9121.230	9121.230	41
Support rails		see page	see page	see page	see page	see page	see page	see page	see page	725
Hinge, exterior	2 pc(s).	9123.000	9123.000	9123.000	9123.000	9123.000	9123.000	9123.000	9123.000	41
Earth straps		see page	see page	see page	see page	see page	see page	see page	see page	762
Cable gland, brass		see page	see page	see page	see page	see page	see page	see page	see page	776
Cable gland, polyamide		see page	see page	see page	see page	see page	see page	see page	see page	776

# Cast aluminium enclosures GA

## Accessories

### Mounting plate

#### for GA

For universal interior installation, with mounting holes.

#### Material:

– Sheet steel

#### Surface finish:

– Zinc-plated

Mounting plate width mm	Mounting plate height mm	For enclosure width mm	For enclosure height mm	Packs of	Model No.
114	69	125	80	10 pc(s).	<b>9105.700</b>
109	107	122	120	2 pc(s).	<b>9108.700</b>
207	107	220	120	2 pc(s).	<b>9110.700</b>
145	142	160	160	2 pc(s).	<b>9112.700</b>
245	142	260	160	2 pc(s).	<b>9113.700</b>
344	142	360	160	1 pc(s).	<b>9114.700</b>
183	214	202	232	1 pc(s).	<b>9116.700</b>
264	214	280	232	1 pc(s).	<b>9117.700</b>
314	214	334 330	233 230	1 pc(s).	<b>9118.700</b>



### Wall mounting bracket

#### for GA

For external mounting on surfaces – no need to remove the cover if pre-assembled.

#### Material:

– Sheet steel

#### Surface finish:

– Zinc-plated

For enclosure height mm	Packs of	Model No.
120	2 pc(s).	<b>9121.122</b>
160	2 pc(s).	<b>9121.160</b>
≥ 230	2 pc(s).	<b>9121.230</b>



### Hinge, exterior

#### for GA

For attaching the cover to the enclosure base.

#### Material:

– Die-cast aluminium

#### Colour:

– RAL 7001

#### Supply includes:

– 2 hinges  
– 8 screws

For enclosure height mm	For enclosure depth mm	Packs of	Model No.
≥ 120	≥ 80	2 pc(s).	<b>9123.000</b>



# Terminal boxes KL



System accessories Page 613 KL stainless steel Page 217 KL for potentially explosive areas Page 232 KL Hygienic Design Page 208

#### Material:

- Enclosure: Sheet steel
- Cover: Sheet steel, all-round foamed-in PU seal

#### Surface finish:

- Enclosure and cover: Dipcoat primed, powder-coated on the outside, textured paint

#### Colour:

- RAL 7035

#### Protection category IP to IEC 60 529:

- IP 66

#### Protection category NEMA:

- NEMA 4

#### Supply includes:

- Enclosure with cover
- Quick-release fastener including plastic bushes

#### Approvals:

- UL
- cUL
- CSA
- TÜV
- Germanischer Lloyd
- Russian Maritime Register of Shipping
- Lloyds Register of Shipping
- Bureau Veritas

## without gland plate

Width mm	Packs of	150	200	200	300	300	400	Page
Height mm		150	150	200	150	200	200	
Depth mm		80	80	80	80	80	80	
Material thickness - enclosure mm		1.25	1.25	1.25	1.25	1.25	1.25	
Material thickness - cover mm		1.25	1.25	1.25	1.25	1.25	1.25	
<b>Model No.</b>	1 pc(s).	<b>1514.510</b>	<b>1528.510</b>	<b>1516.510</b>	<b>1515.510</b>	<b>1517.510</b>	<b>1518.510</b>	
Weight kg		1.4	1.6	1.9	2.1	2.6	3.2	
<b>Accessories</b>								
Mounting plates	1 pc(s).	1560.700	1575.700	1562.700	1561.700	1563.700	1564.700	702
Support rails TS 35/7.5	10 pc(s).	2314.000	2315.000	2315.000	2316.000	2316.000	2317.000	725
Support rails TS 35/15		–	–	–	–	–	–	
Cover retainer	6 pc(s).	1591.000	1591.000	1591.000	1591.000	1591.000	1591.000	684
Cover hinge	6 pc(s).	1592.000	1592.000	1592.000	1592.000	1592.000	1592.000	684
Earthing kit	5 pc(s).	2570.100	2570.100	2570.100	2570.100	2570.100	2570.100	764
Wall mounting bracket	4 pc(s).	1590.000	1590.000	1590.000	1590.000	1590.000	1590.000	698
Spare quick-release fastener	12 pc(s).	1593.000	1593.000	1593.000	1593.000	1593.000	1593.000	



# Terminal boxes KL

## without gland plate

Width mm	Packs of	600	150	200	200	300	300	Page
Height mm		200	150	150	200	150	200	
Depth mm		80	120	120	120	120	120	
Material thickness - enclosure mm		1.25	1.25	1.25	1.25	1.25	1.25	
Material thickness - cover mm		1.25	1.25	1.25	1.25	1.25	1.25	
<b>Model No.</b>	1 pc(s).	<b>1519.510</b>	<b>1500.510</b>	<b>1529.510</b>	<b>1502.510</b>	<b>1501.510</b>	<b>1503.510</b>	
Weight kg		4.6	1.6	1.8	2.3	2.6	3.0	

<b>Accessories</b>								
Mounting plates	1 pc(s).	1566.700	1560.700	1575.700	1562.700	1561.700	1563.700	702
Support rails TS 35/7.5	10 pc(s).	–	2314.000	2315.000	2315.000	2316.000	2316.000	725
Support rails TS 35/15	10 pc(s).	2319.000	–	–	–	–	–	725
Cover retainer	6 pc(s).	1591.000	1591.000	1591.000	1591.000	1591.000	1591.000	684
Cover hinge	6 pc(s).	1592.000	1592.000	1592.000	1592.000	1592.000	1592.000	684
Earthing kit	5 pc(s).	2570.100	2570.100	2570.100	2570.100	2570.100	2570.100	764
Wall mounting bracket	4 pc(s).	1590.000	1590.000	1590.000	1590.000	1590.000	1590.000	698
Spare quick-release fastener	12 pc(s).	1593.000	1593.000	1593.000	1593.000	1593.000	1593.000	

## without gland plate

Width mm	Packs of	300	400	400	400	400	500	Page
Height mm		300	150	200	300	400	200	
Depth mm		120	120	120	120	120	120	
Material thickness - enclosure mm		1.38	1.25	1.25	1.38	1.38	1.25	
Material thickness - cover mm		1.25	1.25	1.25	1.25	1.25	1.25	
<b>Model No.</b>	1 pc(s).	<b>1507.510</b>	<b>1589.510</b>	<b>1504.510</b>	<b>1508.510</b>	<b>1511.510</b>	<b>1505.510</b>	
Weight kg		4.0	3.2	3.6	4.8	6.2	4.4	

<b>Accessories</b>								
Mounting plates	1 pc(s).	1567.700	1576.700	1564.700	1568.700	1571.700	1565.700	702
Support rails TS 35/7.5	10 pc(s).	2316.000	2317.000	2317.000	2317.000	2317.000	–	725
Support rails TS 35/15	10 pc(s).	–	–	–	–	–	2318.000	725
Cover retainer	6 pc(s).	1591.000	1591.000	1591.000	1591.000	1591.000	1591.000	684
Cover hinge	6 pc(s).	1592.000	1592.000	1592.000	1592.000	1592.000	1592.000	684
Earthing kit	5 pc(s).	2570.100	2570.100	2570.100	2570.100	2570.100	2570.100	764
Wall mounting bracket	4 pc(s).	1590.000	1590.000	1590.000	1590.000	1590.000	1590.000	698
Spare quick-release fastener	12 pc(s).	1593.000	1593.000	1593.000	1593.000	1593.000	1593.000	

## without gland plate

Width mm	Packs of	500	600	600	600	800	800	Page
Height mm		300	200	300	400	200	400	
Depth mm		120	120	120	120	120	120	
Material thickness - enclosure mm		1.38	1.25	1.38	1.38	1.25	1.38	
Material thickness - cover mm		1.25	1.25	1.25	1.25	1.25	1.25	
<b>Model No.</b>	1 pc(s).	<b>1509.510</b>	<b>1506.510</b>	<b>1510.510</b>	<b>1512.510</b>	<b>1527.510</b>	<b>1513.510</b>	
Weight kg		5.8	5.7	6.8	8.4	6.8	11.0	

<b>Accessories</b>								
Mounting plates	1 pc(s).	1569.700	1566.700	1570.700	1572.700	1574.700	1573.700	702
Support rails TS 35/7.5		–	–	–	–	–	–	
Support rails TS 35/15	10 pc(s).	2318.000	2319.000	2319.000	2319.000	–	–	725
Cover retainer	6 pc(s).	1591.000	1591.000	1591.000	1591.000	1591.000	1591.000	684
Cover hinge	6 pc(s).	1592.000	1592.000	1592.000	1592.000	1592.000	1592.000	684
Earthing kit	5 pc(s).	2570.100	2570.100	2570.100	2570.100	2570.100	2570.100	764
Wall mounting bracket	4 pc(s).	1590.000	1590.000	1590.000	1590.000	1590.000	1590.000	698
Spare quick-release fastener	12 pc(s).	1593.000	1593.000	1593.000	1593.000	1593.000	1593.000	

# Terminal boxes KL



**System accessories** Page 613 **KL stainless steel** Page 217 **KL for potentially explosive areas** Page 232 **KL Hygienic Design** Page 208

#### Material:

- Enclosure: Sheet steel
- Cover: Sheet steel, all-round foamed-in PU seal

#### Surface finish:

- Enclosure and cover: Dipcoat primed, powder-coated on the outside, textured paint

#### Colour:

- RAL 7035

#### Protection category IP to IEC 60 529:

- IP 55

#### Protection category NEMA:

- NEMA 12

#### Supply includes:

- Enclosure with cover
  - Quick-release fastener including plastic bushes
  - Sheet steel gland plates with seals and assembly parts
- Please observe the product-specific scope of supply.

#### Approvals:

- UL
- cUL
- CSA
- TÜV
- Germanischer Lloyd
- Russian Maritime Register of Shipping
- Lloyds Register of Shipping
- Bureau Veritas

## with gland plate

Width mm	Packs of	300	300	300	400	400	400	500	Page
Height mm		150	200	300	200	300	400	200	
Depth mm		120	120	120	120	120	120	120	
Material thickness - enclosure mm		1.25	1.25	1.38	1.25	1.38	1.38	1.25	
Material thickness - cover mm		1.25	1.25	1.25	1.25	1.25	1.25	1.25	
<b>Model No.</b>	1 pc(s).	<b>1530.510</b>	<b>1531.510</b>	<b>1535.510</b>	<b>1532.510</b>	<b>1536.510</b>	<b>1539.510</b>	<b>1533.510</b>	
Weight kg		2.7	3.3	4.5	4.0	5.2	6.7	4.9	
<b>Product-specific scope of supply</b>									
Gland plate (top + bottom), Size		2	2	2	2	2	2	2	
Gland plate (top + bottom), Qty.		1 + 1	1 + 1	1 + 1	1 + 1	1 + 1	1 + 1	2 + 2	
Gland plate (left + right), Size		–	–	2	–	2	2	–	
Gland plate (left + right), Qty.		–	–	1 + 1	–	1 + 1	1 + 1	–	
<b>Accessories</b>									
Mounting plates	1 pc(s).	1561.700	1563.700	1567.700	1564.700	1568.700	1571.700	1565.700	702
Plastic cable gland plates		see page	see page	see page	see page	see page	see page	see page	771
Metal gland plates	1 pc(s).	1581.100	1581.100	1581.100	1581.100	1581.100	1581.100	1581.100	773
Support rails TS 35/7.5	10 pc(s).	2316.000	2316.000	2316.000	2317.000	2317.000	2317.000	–	725
Support rails TS 35/15	10 pc(s).	–	–	–	–	–	–	2318.000	725
Cover retainer	6 pc(s).	1591.000	1591.000	1591.000	1591.000	1591.000	1591.000	1591.000	684
Cover hinge	6 pc(s).	1592.000	1592.000	1592.000	1592.000	1592.000	1592.000	1592.000	684
Earthing kit	5 pc(s).	2570.100	2570.100	2570.100	2570.100	2570.100	2570.100	2570.100	764
Wall mounting bracket	4 pc(s).	1590.000	1590.000	1590.000	1590.000	1590.000	1590.000	1590.000	698
Spare quick-release fastener	12 pc(s).	1593.000	1593.000	1593.000	1593.000	1593.000	1593.000	1593.000	

# Terminal boxes KL

with gland plate

Width mm	Packs of	500	600	600	600	800	800	Page
Height mm		300	200	300	400	200	400	
Depth mm		120	120	120	120	120	120	
Material thickness - enclosure mm		1.38	1.25	1.38	1.38	1.25	1.38	
Material thickness - cover mm		1.25	1.25	1.25	1.25	1.25	1.25	
<b>Model No.</b>	1 pc(s).	<b>1537.510</b>	<b>1534.510</b>	<b>1538.510</b>	<b>1540.510</b>	<b>1542.510</b>	<b>1541.510</b>	
Weight kg		5.2	5.9	7.7	9.0	7.2	12.0	
<b>Product-specific scope of supply</b>								
Gland plate (top + bottom), Size		2	2	2	2	2	2	
Gland plate (top + bottom), Qty.		2 + 2	2 + 2	2 + 2	2 + 2	3 + 3	3 + 3	
Gland plate (left + right), Size		2	-	2	2	-	2	
Gland plate (left + right), Qty.		1 + 1	-	1 + 1	1 + 1	-	1 + 1	
<b>Accessories</b>								
Mounting plates	1 pc(s).	1569.700	1566.700	1570.700	1572.700	1574.700	1573.700	702
Plastic cable gland plates		see page	see page	see page	see page	see page	see page	771
Metal gland plates	1 pc(s).	1581.100	1581.100	1581.100	1581.100	1581.100	1581.100	773
Support rails TS 35/7.5		-	-	-	-	-	-	
Support rails TS 35/15	10 pc(s).	2318.000	2319.000	2319.000	2319.000	-	-	725
Cover retainer	6 pc(s).	1591.000	1591.000	1591.000	1591.000	1591.000	1591.000	684
Cover hinge	6 pc(s).	1592.000	1592.000	1592.000	1592.000	1592.000	1592.000	684
Earthing kit	5 pc(s).	2570.100	2570.100	2570.100	2570.100	2570.100	2570.100	764
Wall mounting bracket	4 pc(s).	1590.000	1590.000	1590.000	1590.000	1590.000	1590.000	698
Spare quick-release fastener	12 pc(s).	1593.000	1593.000	1593.000	1593.000	1593.000	1593.000	

Accessories

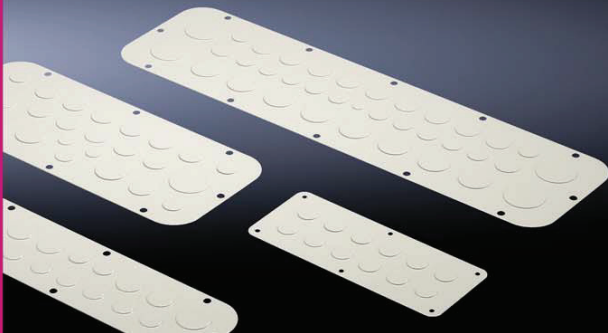

## Metal gland plates

see page 773

Accessories

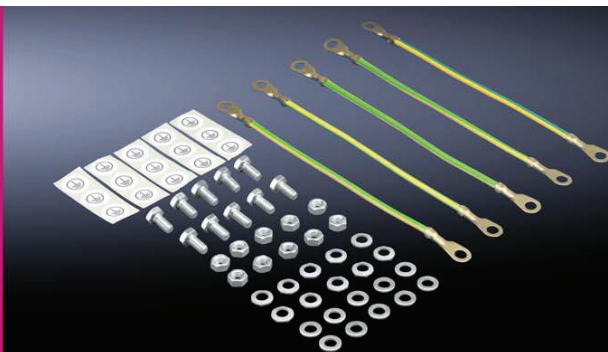

## Earthing set

see from page 764

# E-Box EB

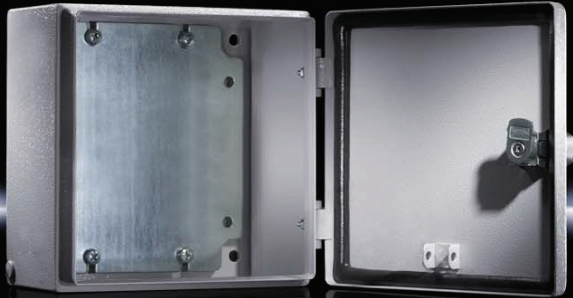

**System accessories** Page 613

**Material:**

- Enclosure and door: Sheet steel, all-round foamed-in PU seal

**Surface finish:**

- Enclosure and door: Dipcoat primed, powder-coated on the outside, textured paint
- Mounting plate: Zinc-plated

**Colour:**

- RAL 7035

**Protection category IP to IEC 60 529:**

- IP 66

**Protection category NEMA:**

- NEMA 4

**Supply includes:**

- Enclosure with hinged door
- 180° hinge
- Cam lock with 3 mm double-bit insert
- Mounting plate

**Approvals:**

- UL
- cUL
- CSA
- TÜV
- Russian Maritime Register of Shipping
- Lloyds Register of Shipping
- Bureau Veritas

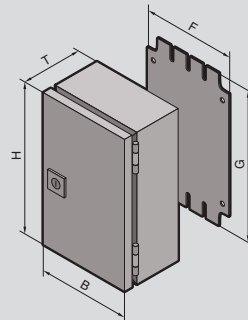

## Depth 80 mm

Width (B) mm	Packs of	150	150	200	200	200	Page
<b>Height (H) mm</b>		150	300	200	300	400	
<b>Depth (T) mm</b>		80	80	80	80	80	
Mounting plate width (F) mm		125	125	175	175	175	
Mounting plate height (G) mm		135	285	185	285	385	
Material thickness - enclosure mm		1.25	1.25	1.25	1.25	1.25	
Material thickness - door mm		1.25	1.25	1.25	1.25	1.25	
<b>Model No.</b>	1 pc(s).	<b>1551.500</b>	<b>1545.500</b>	<b>1546.500</b>	<b>1552.500</b>	<b>1547.500</b>	
Weight kg		1.7	2.6	2.4	3.2	4.4	
Number of locks		1	1	1	1	1	

<b>Accessories</b>							
Wall mounting bracket	4 pc(s).	1590.000	1590.000	1590.000	1590.000	1590.000	698
Pole clamp	2 pc(s).	2584.000	2584.000	2584.000	2584.000	2584.000	700
Mounting clip	30 pc(s).	2309.000	2309.000	2309.000	2309.000	2309.000	725
Support rails		see page	see page	see page	see page	see page	725
Earth straps		see page	see page	see page	see page	see page	762
Cable gland, brass		see page	see page	see page	see page	see page	776
Cable gland, polyamide		see page	see page	see page	see page	see page	776
Plastic handles		see page	see page	see page	see page	see page	679
T handles		see page	see page	see page	see page	see page	679
Lock inserts		see page	see page	see page	see page	see page	680
Lock cylinder inserts	1 pc(s).	2571.000	2571.000	2571.000	2571.000	2571.000	681
Lock cover	2 pc(s).	2476.000	2476.000	2476.000	2476.000	2476.000	681

## Depth 120 mm

Width (B) mm	Packs of	150	150	200	200	200	200	300	300	Page
<b>Height (H) mm</b>		150	300	200	300	400	500	300	400	
<b>Depth (T) mm</b>		120	120	120	120	120	120	120	120	
Mounting plate width (F) mm		125	125	175	175	175	175	275	275	
Mounting plate height (G) mm		135	285	185	285	385	485	285	385	
Material thickness - enclosure mm		1.25	1.25	1.25	1.25	1.25	1.25	1.38	1.38	
Material thickness - door mm		1.25	1.25	1.25	1.25	1.25	1.25	1.25	1.25	
<b>Model No.</b>	1 pc(s).	<b>1553.500</b>	<b>1548.500</b>	<b>1549.500</b>	<b>1554.500</b>	<b>1550.500</b>	<b>1557.500</b>	<b>1555.500</b>	<b>1556.500</b>	
Weight kg		2.0	3.0	2.8	3.6	5.0	6.2	5.0	6.4	
Number of locks		1	1	1	1	1	2	1	1	
<b>Accessories</b>										
Wall mounting bracket	4 pc(s).	1590.000	1590.000	1590.000	1590.000	1590.000	1590.000	1590.000	1590.000	698
Pole clamp	2 pc(s).	2584.000	2584.000	2584.000	2584.000	2584.000	2584.000	2584.000	2584.000	700
Mounting clip	30 pc(s).	2309.000	2309.000	2309.000	2309.000	2309.000	2309.000	2309.000	2309.000	725
Support rails		see page	see page	see page	see page	see page	see page	see page	see page	725
Earth straps		see page	see page	see page	see page	see page	see page	see page	see page	762
Cable gland, brass		see page	see page	see page	see page	see page	see page	see page	see page	776
Cable gland, polyamide		see page	see page	see page	see page	see page	see page	see page	see page	776
Plastic handles		see page	see page	see page	see page	see page	see page	see page	see page	679
T handles		see page	see page	see page	see page	see page	see page	see page	see page	679
Lock inserts		see page	see page	see page	see page	see page	see page	see page	see page	680
Lock cylinder inserts	1 pc(s).	2571.000	2571.000	2571.000	2571.000	2571.000	2571.000	2571.000	2571.000	681
Lock cover	2 pc(s).	2476.000	2476.000	2476.000	2476.000	2476.000	2476.000	2476.000	2476.000	681

## Depth 155 mm

Width (B) mm	Packs of	300	300	300	Page
<b>Height (H) mm</b>		400	600	800	
<b>Depth (T) mm</b>		155	155	155	
Mounting plate width (F) mm		275	275	275	
Mounting plate height (G) mm		385	585	785	
Material thickness - enclosure mm		1.38	1.38	1.38	
Material thickness - door mm		1.25	1.25	1.25	
<b>Model No.</b>	1 pc(s).	<b>1577.500</b>	<b>1578.500</b>	<b>1579.500</b>	
Weight kg		7.1	11.0	13.2	
Number of locks		1	2	2	
<b>Accessories</b>					
Wall mounting bracket	4 pc(s).	1590.000	1590.000	1590.000	698
Pole clamp	2 pc(s).	2584.000	2584.000	2584.000	700
Mounting clip	30 pc(s).	2309.000	2309.000	2309.000	725
Support rails		see page	see page	see page	725
Earth straps		see page	see page	see page	762
Cable gland, brass		see page	see page	see page	776
Cable gland, polyamide		see page	see page	see page	776
Plastic handles		see page	see page	see page	679
T handles		see page	see page	see page	679
Lock inserts		see page	see page	see page	680
Lock cylinder inserts	1 pc(s).	2571.000	2571.000	2571.000	681
Lock cover	2 pc(s).	2476.000	2476.000	2476.000	681

# Bus enclosures BG



System accessories Page 613 **BG stainless steel** Page 218

#### Material:

- Enclosure: Sheet steel
- Door: Sheet steel with polycarbonate viewing window, 4 mm

#### Surface finish:

- Enclosure and door: Dipcoat-primed, powder-coated, textured paint

#### Colour:

- RAL 7035

#### Protection category IP to IEC 60 529:

- IP 65

#### NEMA protection category:

- NEMA 12

#### Supply includes:

- Enclosure with door
  - Viewing window in the door
- Please note the product-specific scope of supply.

#### Approvals:

- UL
- cUL
- TÜV
- Lloyds Register of Shipping

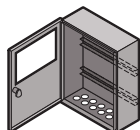

Width mm	P. of	200	300	400	500	Page
<b>Height mm</b>		300	300	300	300	
<b>Depth mm</b>		80	80	80	80	
<b>Model No.</b>	1 pc(s).	<b>1583.520</b>	<b>1584.520</b>	<b>1585.520</b>	<b>1586.520</b>	
Material thickness mm	Enclosure	1.25	1.25	1.25	1.25	
	Door	1.25	1.25	1.25	1.25	
<b>Product-specific scope of supply</b>						
Door hinge		left	left	left	left	
Cam lock with double-bit insert		1	1	1	1	
Support rail TS 35/7.5		2	2	2	2	
Number of metric holes	M12	2	2	2	3	
	M20	5	9	13	24	
	M25	2	2	3	–	
<b>Accessories</b>						
Lock cover	1 pc(s).	2476.000	2476.000	2476.000	2476.000	682
Wall mounting bracket	4 pc(s).	1590.000	1590.000	1590.000	1590.000	698
Pole clamp	1 pc(s).	2584.000	2584.000	2584.000	2584.000	700
Lock inserts, type A		see page 680				
Lock cylinder inserts, type B		see page 681				
Plastic handles, type B		see page 679				

# Bus enclosures BG

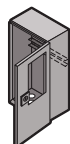

Width mm	P. of	200	400	Page
Height mm		300	300	
Depth mm		120	120	
<b>Model No.</b>	1 pc(s).	<b>1605.520</b>	<b>1606.520</b>	
Material thickness mm	Enclosure	1.25	1.38	
	Door	1.25	1.25	
<b>Product-specific scope of supply</b>				
Door hinge		right	right	
Cam lock with double-bit insert		1	1	
Support rail TS 35/7.5		1	1	
Number of metric holes	M12	2	–	
	M20	–	2	
	M32	5	9	
	M50	–	1	
<b>Accessories</b>				
Lock cover	1 pc(s).	2476.000	2476.000	682
Wall mounting bracket	4 pc(s).	1590.000	1590.000	698
Pole clamp	1 pc(s).	2584.000	2584.000	700
Lock inserts, type A			see page 680	
Lock cylinder inserts, type B			see page 681	
Plastic handles, type B			see page 679	

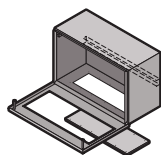

Width mm	P. of	400	600	Page
Height mm		200	200	
Depth mm		125	125	
<b>Model No.</b>	1 pc(s).	<b>1558.510</b>	<b>1559.510</b>	
Material thickness mm	Enclosure	1.25	1.25	
	Door	1.25	1.25	
<b>Product-specific scope of supply</b>				
Door hinge		bottom	bottom	
Quick-release fastener		2	3	
Support rail TS 35/7.5		1	1	
Gland plate in the base		1	1	
<b>Accessories</b>				
Wall mounting bracket	4 pc(s).	1590.000	1590.000	698
Pole clamp	1 pc(s).	2584.000	2584.000	700

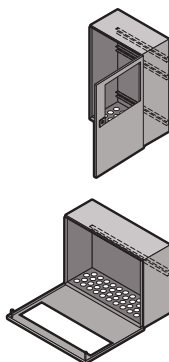

Width mm	P. of	400	500	Page
Height mm		500	300	
Depth mm		160	120	
<b>Model No.</b>	1 pc(s).	<b>1611.510</b>	<b>1609.510</b>	
Material thickness mm	Enclosure	1.38	1.38	
	Door	1.5	1.25	
<b>Product-specific scope of supply</b>				
Door hinge		right	bottom	
Cam lock with double-bit insert		1	–	
Quick-release fastener		–	2	
Support rail TS 35/7.5		3	1	
Number of drilled holes for PG 13.5 or M20		33	48	
<b>Accessories</b>				
Lock cover	1 pc(s).	2476.000	–	682
Wall mounting bracket	4 pc(s).	1590.000	1590.000	698
Pole clamp	1 pc(s).	2584.000	2584.000	700
Lock inserts, type A			see page 680	
Lock cylinder inserts, type B			see page 681	
Plastic handles, type B			see page 679	

# Bus enclosures BG

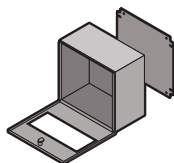

<b>Width</b> mm	P. of	400	400	400	Page
<b>Height</b> mm		300	300	300	
<b>Depth</b> mm		155	155	155	
Mounting plate width		385	385	385	
Mounting plate height		275	275	275	
<b>Model No.</b>	1 pc(s).	<b>1577.500</b>	<b>1577.530</b>	<b>1577.450</b>	
Material thickness mm	Enclosure	1.38	1.38	1.38	
	Door	1.25	1.25	1.25	

### Product-specific scope of supply

Door hinge		bottom	bottom	bottom	
Cam lock with double-bit insert		1	1	1	
Viewing window	Size mm	-	340 x 190	340 x 155	
	Position <sup>1)</sup> mm	-	42	92	
Mounting plate		1	1	1	
Gland plate in the base		-	-	-	

### Accessories

Lock cover	1 pc(s).	2476.000	2476.000	2476.000	682
Wall mounting bracket	4 pc(s).	1590.000	1590.000	1590.000	698
Pole clamp	1 pc(s).	2584.000	2584.000	2584.000	700
Lock inserts, type A					see page 680
Lock cylinder inserts, type B					see page 681
Plastic handles, type B					see page 679

<sup>1)</sup> Bottom edge of window to bottom edge of door

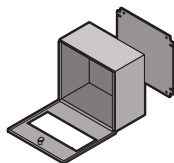

<b>Width</b> mm	P. of	600	600	600	Page
<b>Height</b> mm		300	300	300	
<b>Depth</b> mm		155	155	155	
Mounting plate width		585	585	585	
Mounting plate height		275	275	275	
<b>Model No.</b>	1 pc(s).	<b>1578.500</b>	<b>1578.530</b>	<b>1578.450</b>	
Material thickness mm	Enclosure	1.38	1.38	1.38	
	Door	1.25	1.25	1.25	

### Product-specific scope of supply

Door hinge		bottom	bottom	bottom	
Cam lock with double-bit insert		2	2	2	
Viewing window	Size mm	-	540 x 190	540 x 155	
	Position <sup>1)</sup> mm	-	42	92	
Mounting plate		1	1	1	
Gland plate in the base		-	-	-	

### Accessories

Lock cover	1 pc(s).	2476.000	2476.000	2476.000	682
Wall mounting bracket	4 pc(s).	1590.000	1590.000	1590.000	698
Pole clamp	1 pc(s).	2584.000	2584.000	2584.000	700
Lock inserts, type A					see page 680
Lock cylinder inserts, type B					see page 681
Plastic handles, type B					see page 679

<sup>1)</sup> Bottom edge of window to bottom edge of door



# Bus enclosures BG

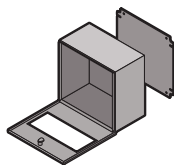

<b>Width mm</b>	P. of	800	800	800	Page
<b>Height mm</b>		300	300	300	
<b>Depth mm</b>		155	155	155	
Mounting plate width		785	785	785	
Mounting plate height		275	275	275	
<b>Model No.</b>	1 pc(s).	<b>1579.500</b>	<b>1579.530</b>	<b>1579.450</b>	
Material thickness mm	Enclosure	1.38	1.38	1.38	
	Door	1.25	1.25	1.25	

### Product-specific scope of supply

Door hinge		bottom	bottom	bottom	
Cam lock with double-bit insert		2	2	2	
Viewing window	Size mm	-	740 x 190	740 x 155	
	Position <sup>1)</sup> mm	-	42	92	
Mounting plate		1	1	1	
Gland plate in the base		-	-	-	

### Accessories

Lock cover	1 pc(s).	2476.000	2476.000	2476.000	682
Wall mounting bracket	4 pc(s).	1590.000	1590.000	1590.000	698
Pole clamp	1 pc(s).	2584.000	2584.000	2584.000	700
Lock inserts, type A				see page 680	
Lock cylinder inserts, type B				see page 681	
Plastic handles, type B				see page 679	

<sup>1)</sup> Bottom edge of window to bottom edge of door



New

## Rittal Automation Systems tools

see page 865

# Rittal – The System.

Faster – better – everywhere.

